

Bestuhlungsvarianten für den Spiegelsaal

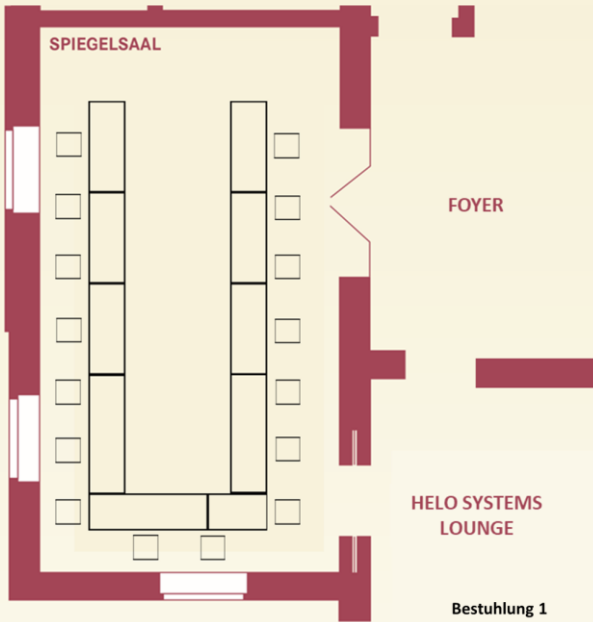

HELO SYSTEMS
LOUNGE

Bestuhlung 1
U-Form
bis 16 Personen

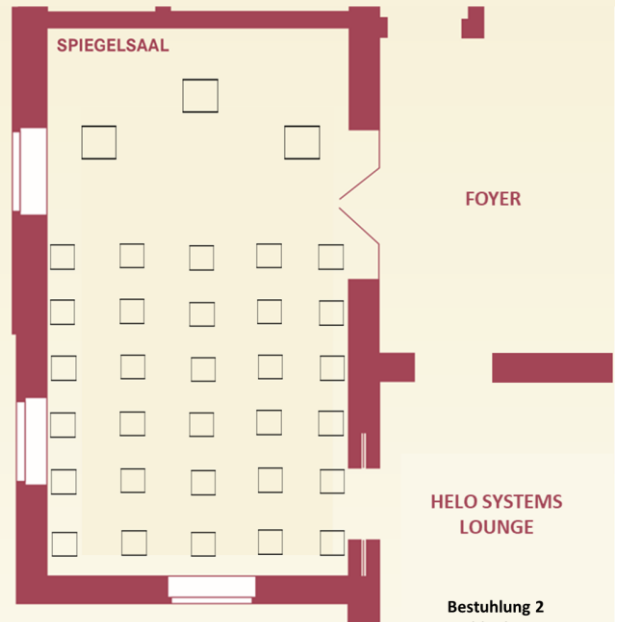

HELO SYSTEMS
LOUNGE

Bestuhlung 2
Stuhlreihe
bis 33 Personen

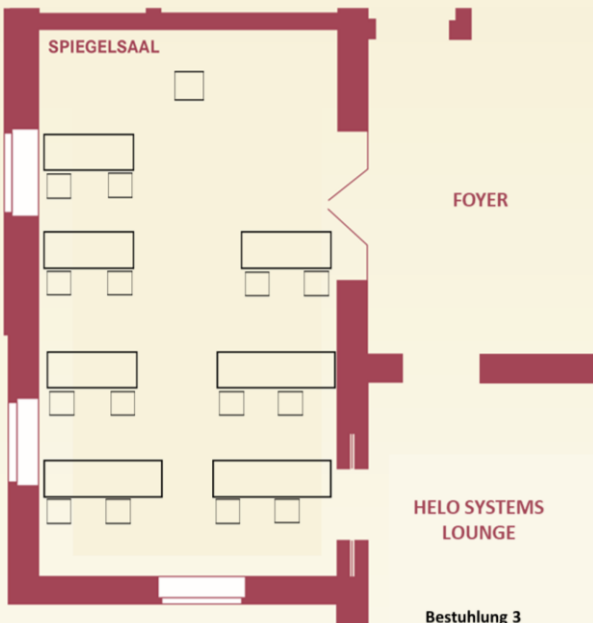

HELO SYSTEMS
LOUNGE

Bestuhlung 3
Parlamentarisch
bis 15 Personen

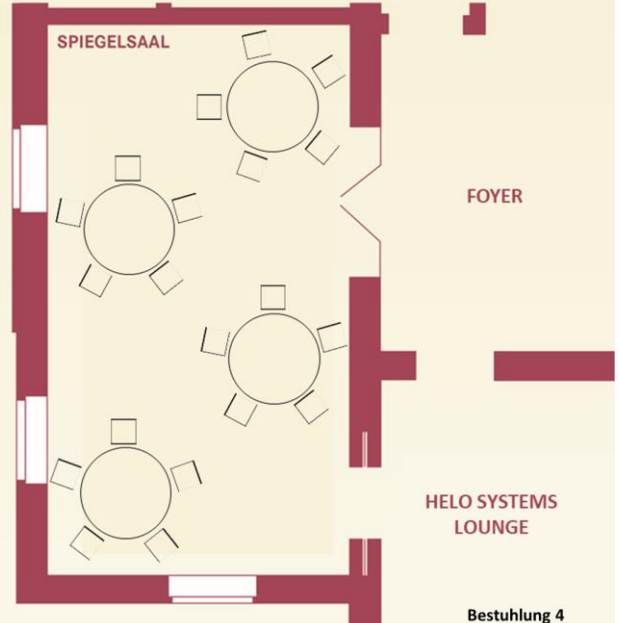

HELO SYSTEMS
LOUNGE

Bestuhlung 4
Bankett-Stil
bis 20 Personen

Bestuhlungsvarianten für den Spiegelsaal

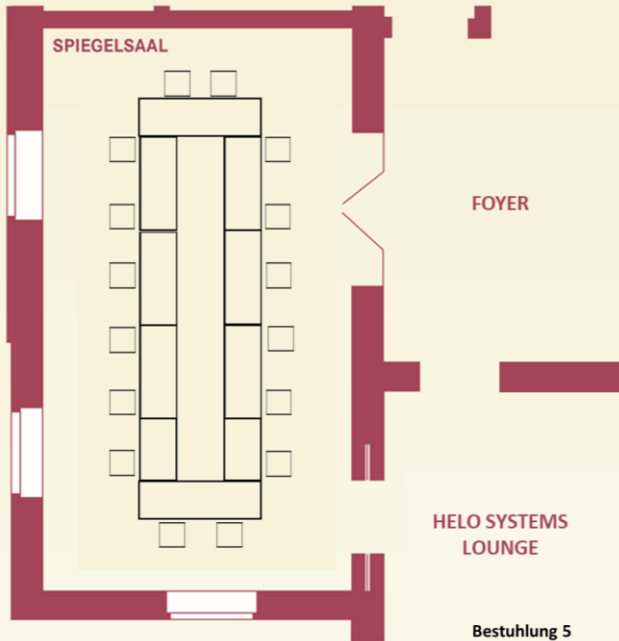

Bestuhlung 5
Block
bis 16 Personen

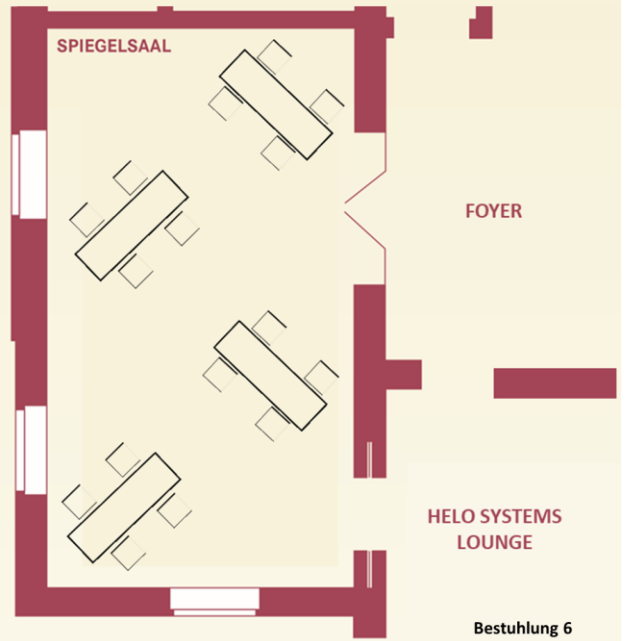

Bestuhlung 6
Fischgräte
bis 16 Personen

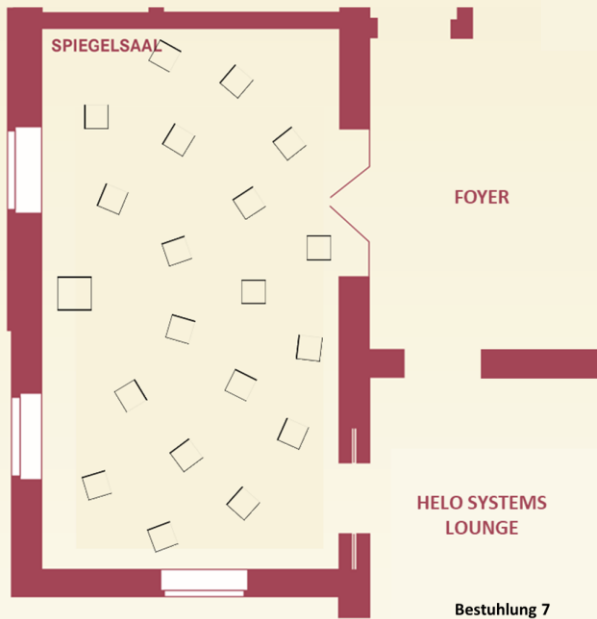

Bestuhlung 7
Halbkreis
bis 20 Personen

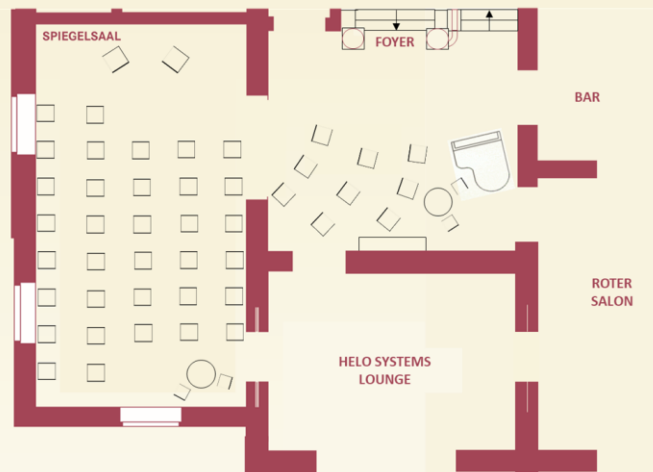

Bestuhlung 8
Stuhreihe + Foyer
bis 49 Personen

Bestuhlungsvarianten für den roten Salon

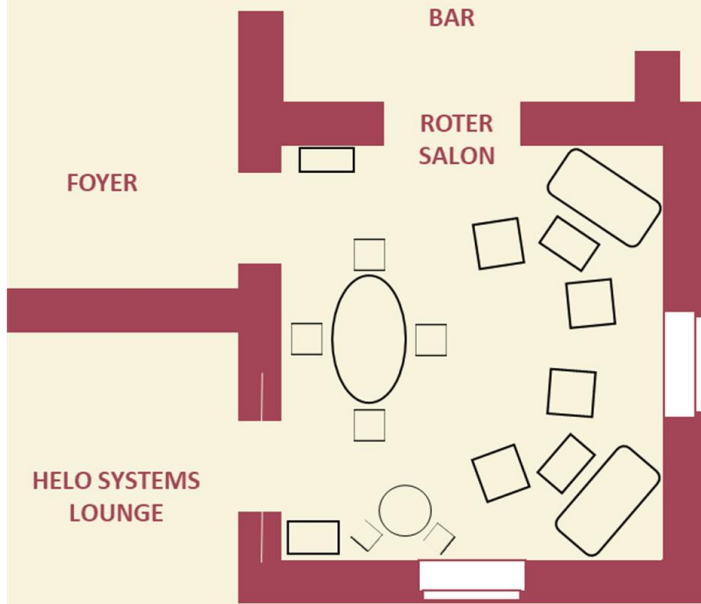

Bestuhlung 1

Lounge
12 Personen

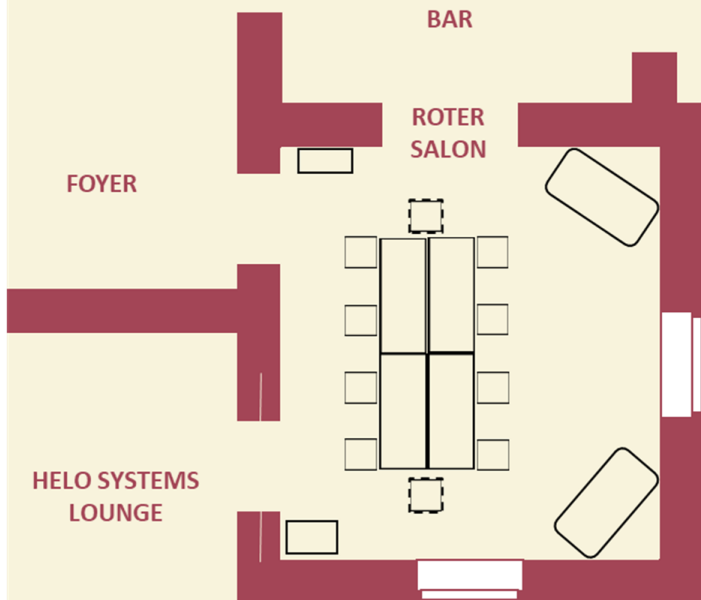

Bestuhlung 2

Block
bis 10 Personen

Bestuhlungsvarianten für die Helo Systems Lounge

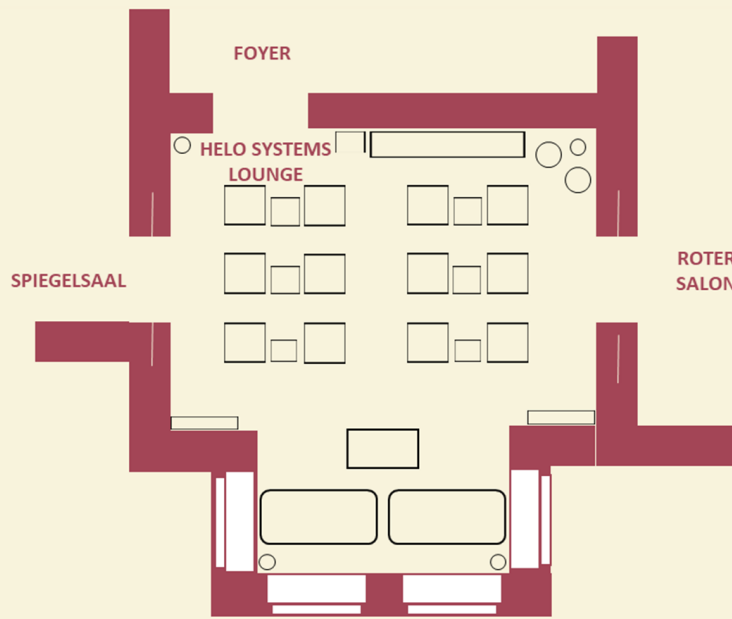

Bestuhlung 1
Lounge
12 Personen

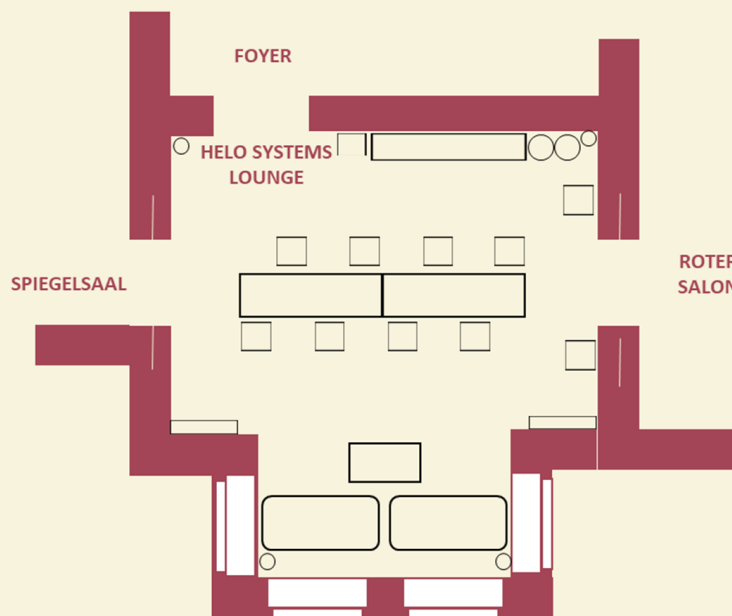

Bestuhlung 2
Tafel
bis 8 Personen