

Bestuhlungsvarianten für den Spiegelsaal

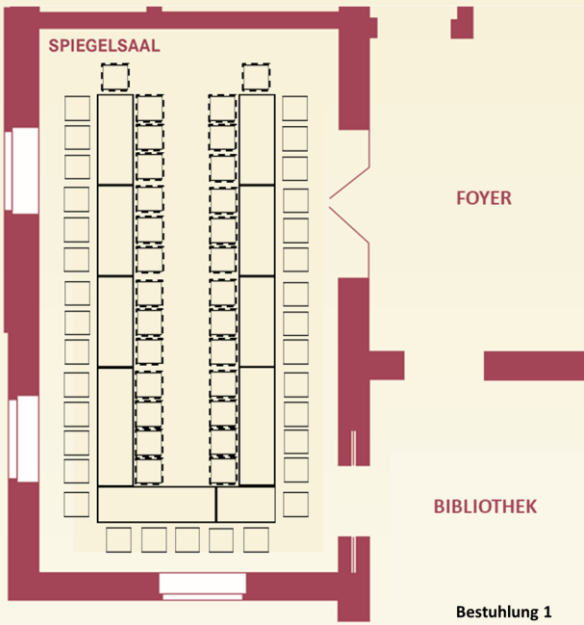

Bestuhlung 1
U-Form
bis 61 Personen

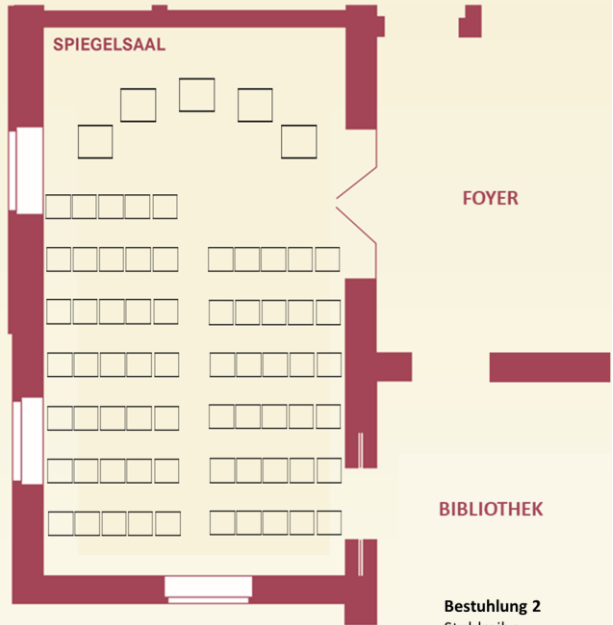

Bestuhlung 2
Stuhlreihe
bis 65 Personen



Bestuhlung 3
Parlamentarisch
bis 30 Personen

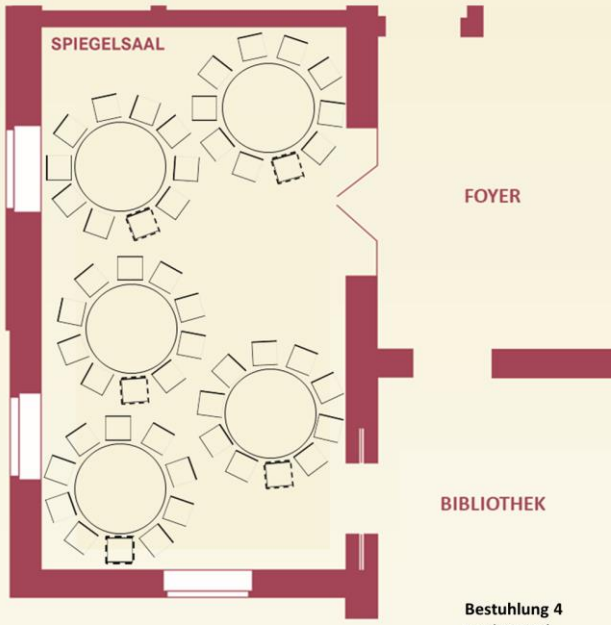

Bestuhlung 4
Bankett-Stil
bis 50 Personen

Bestuhlungsvarianten für den Spiegelsaal

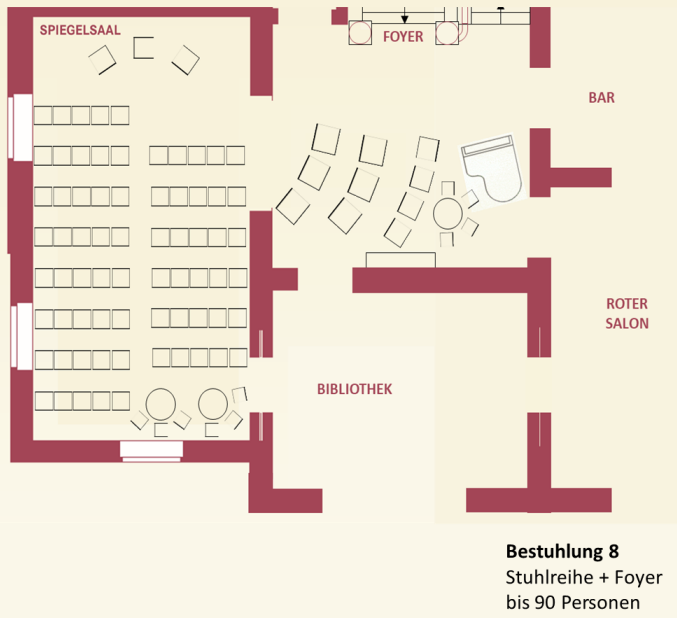
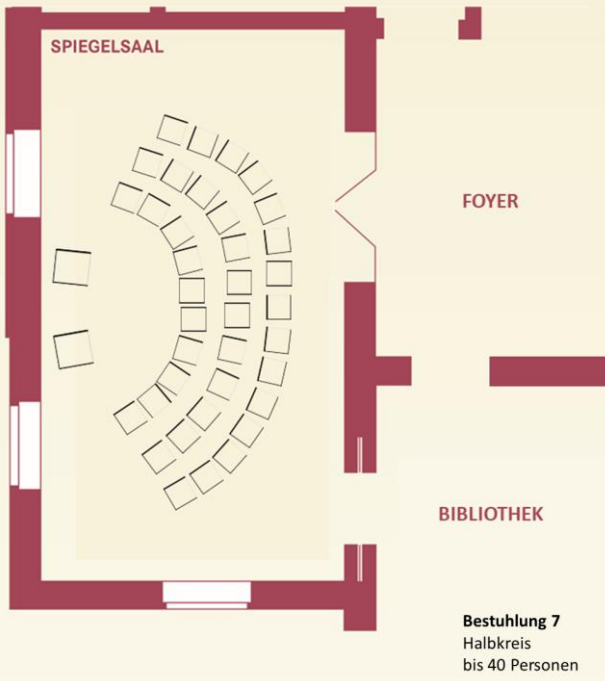
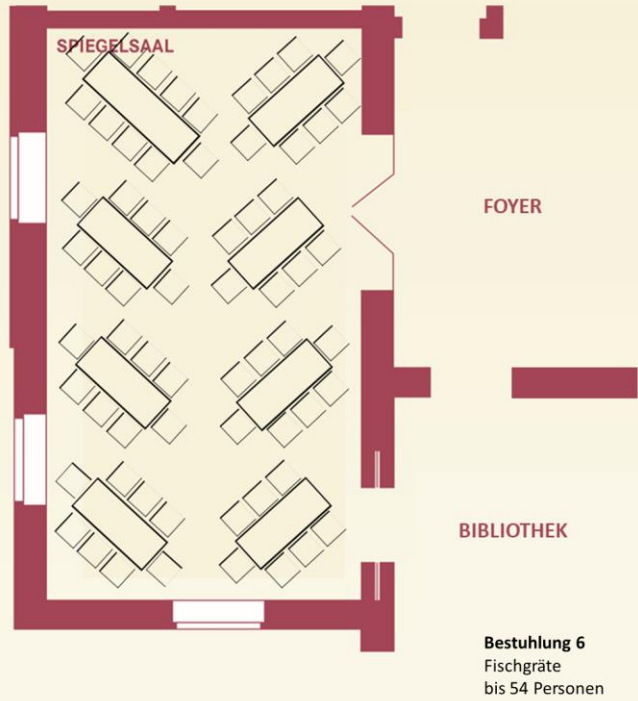
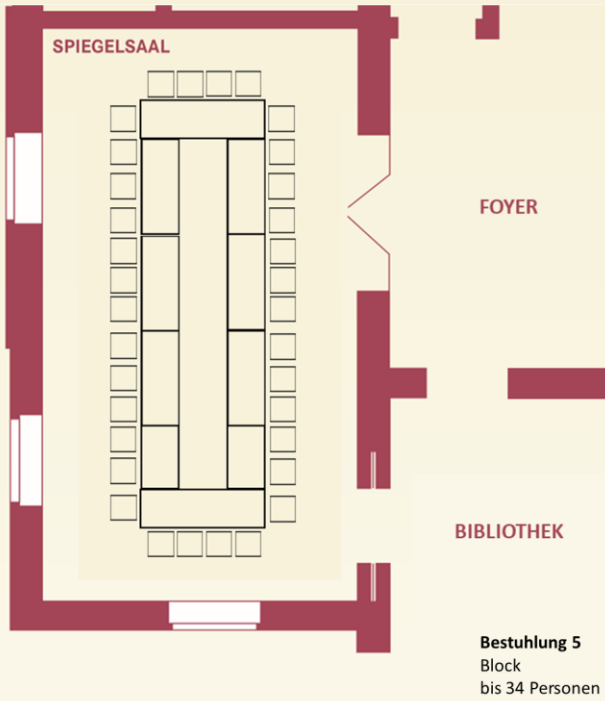

Bestuhlungsvarianten für den roten Salon

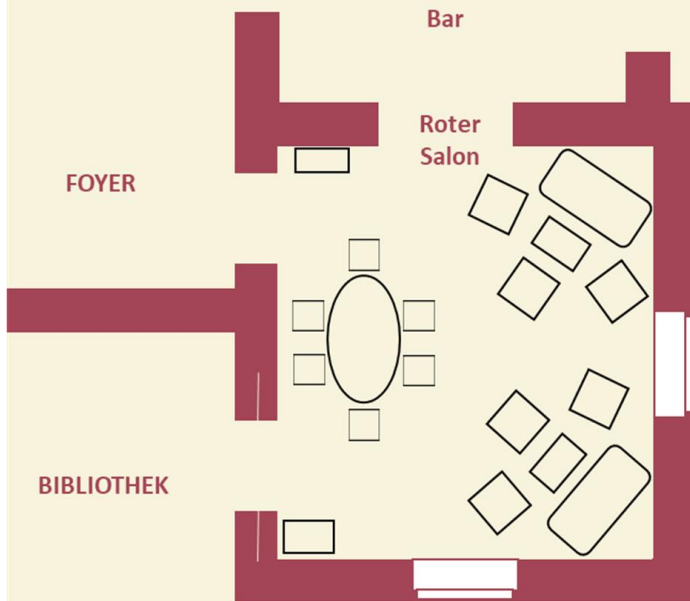

Bestuhlung 1
Lounge
16 Personen

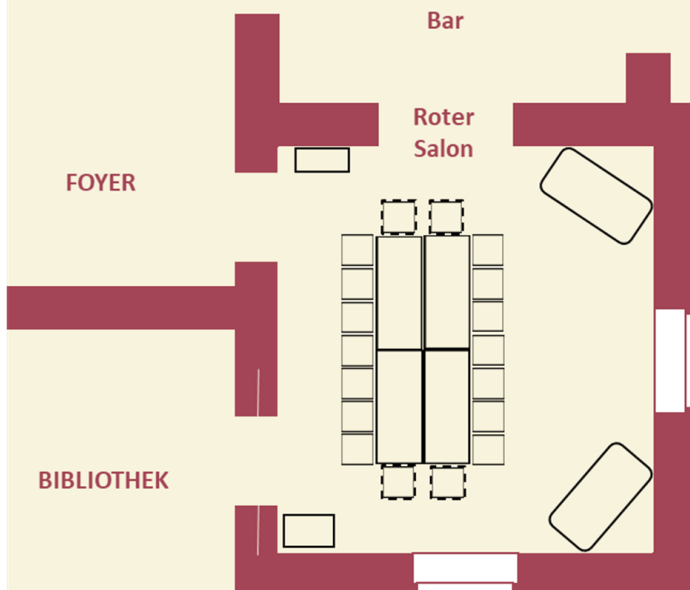

Bestuhlung 2
Block
bis 18 Personen

Bestuhlungsvarianten für die Bibliothek

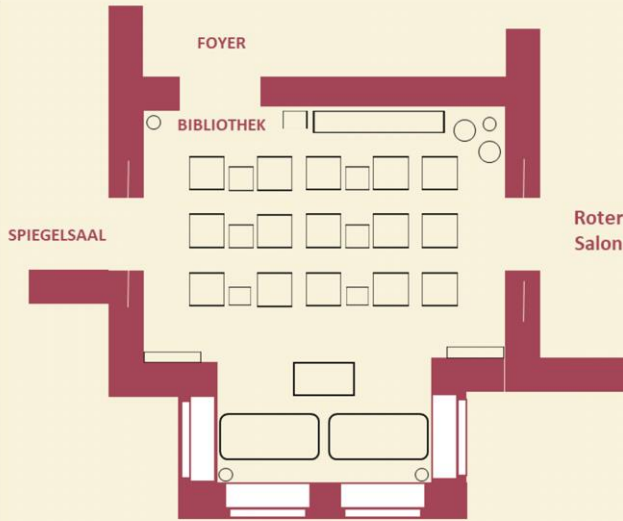

Bestuhlung 1
Lounge
19 Personen

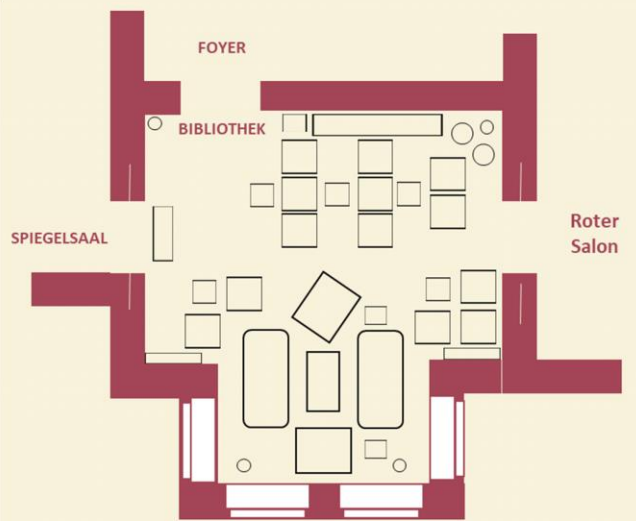

Bestuhlung 2
Lounge
20 Personen

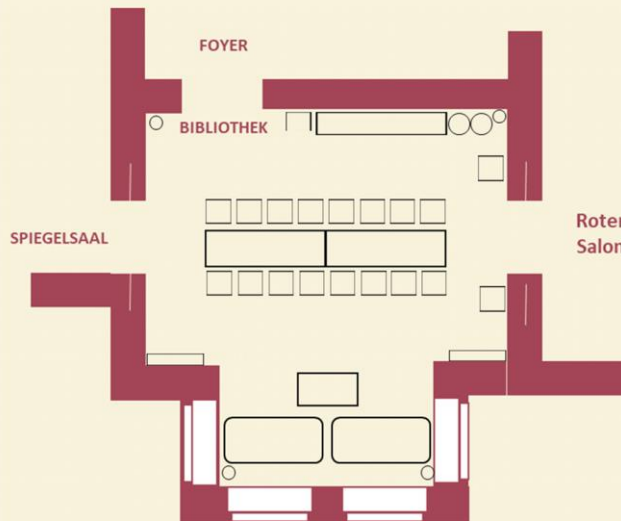

Bestuhlung 3
Tafel
16 Personen