

Bestuhlungsvarianten für den Spiegelsaal

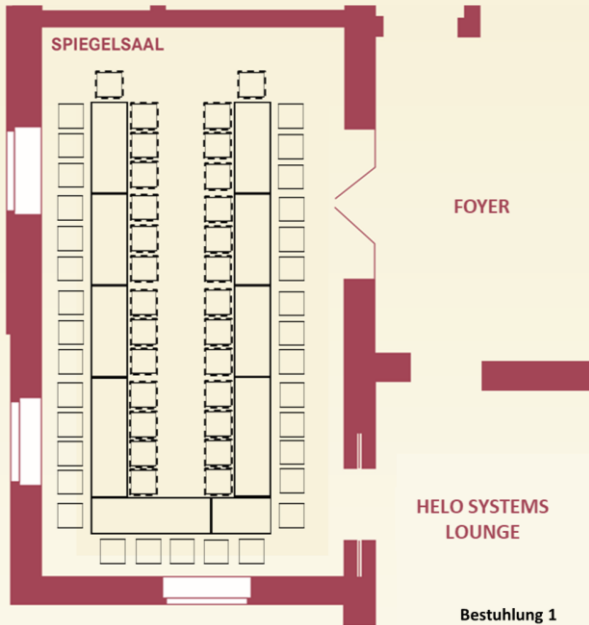

FOYER

HELO SYSTEMS LOUNGE

Bestuhlung 1
U-Form
bis 61 Personen

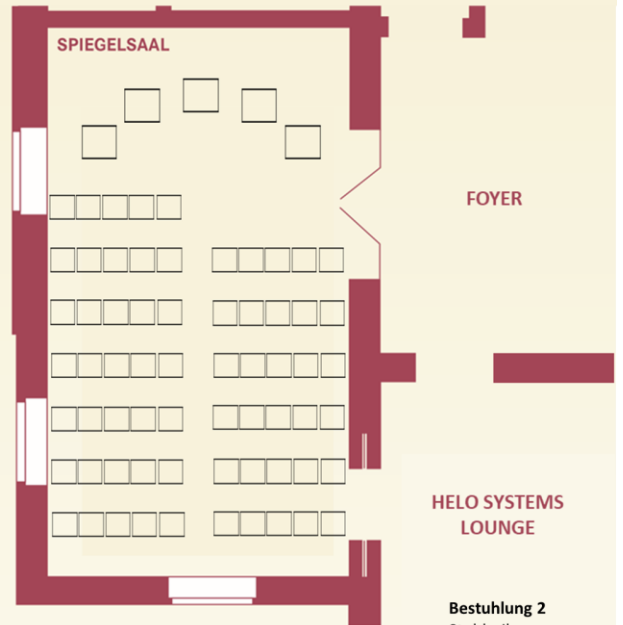

FOYER

HELO SYSTEMS LOUNGE

Bestuhlung 2
Stuhlreihe
bis 65 Personen

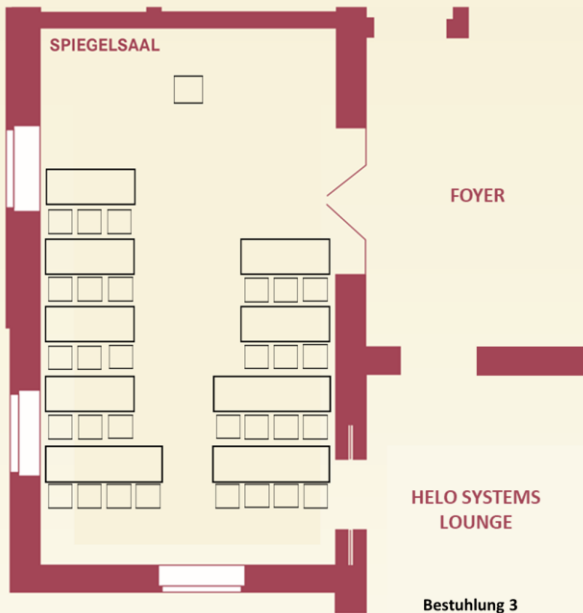

FOYER

HELO SYSTEMS LOUNGE

Bestuhlung 3
Parlamentarisch
bis 30 Personen

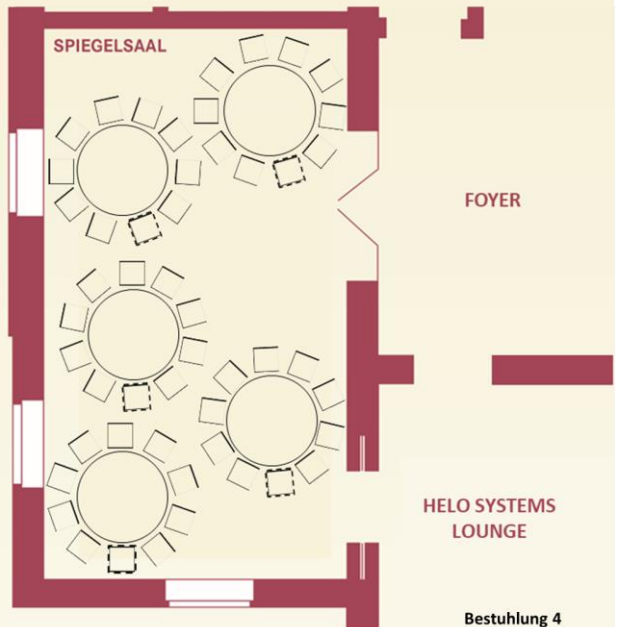

FOYER

HELO SYSTEMS LOUNGE

Bestuhlung 4
Bankett-Stil
bis 50 Personen

Bestuhlungsvarianten für den Spiegelsaal

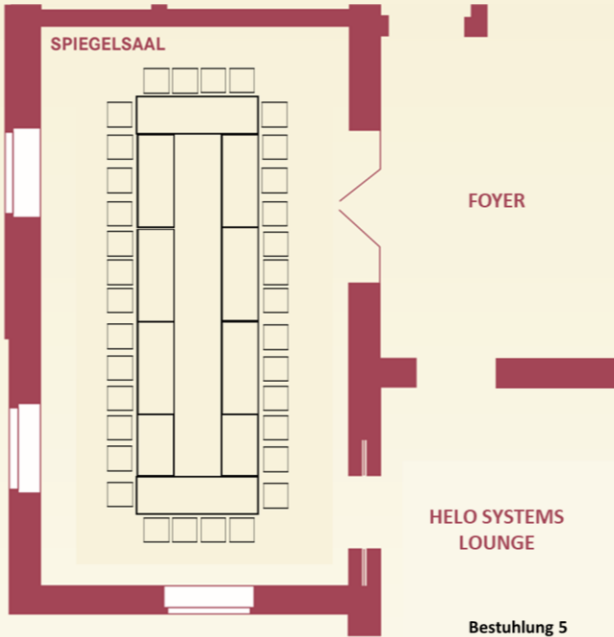

Bestuhlung 5
Block
bis 34 Personen

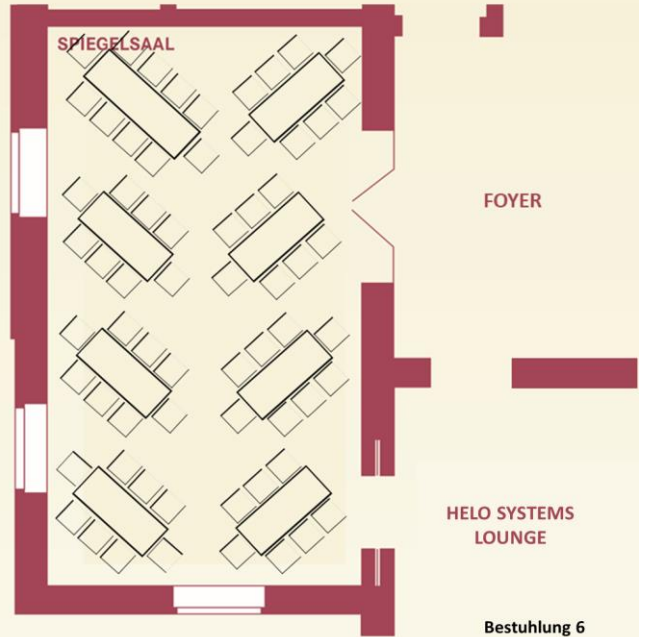

Bestuhlung 6
Fischgräte
bis 54 Personen

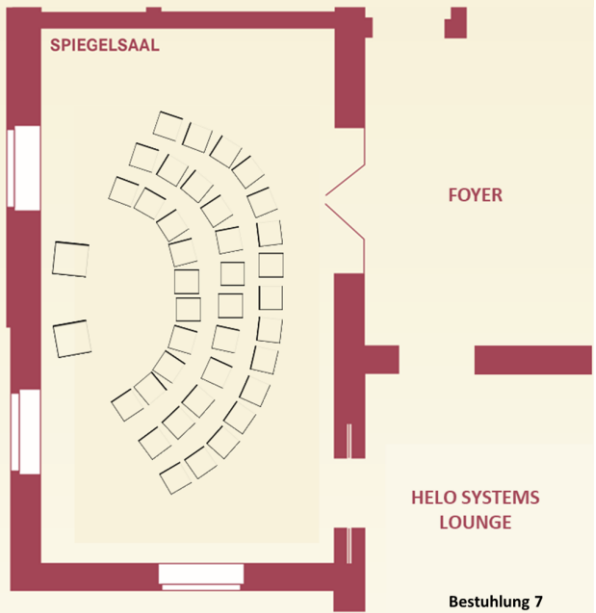

Bestuhlung 7
Halbkreis
bis 40 Personen

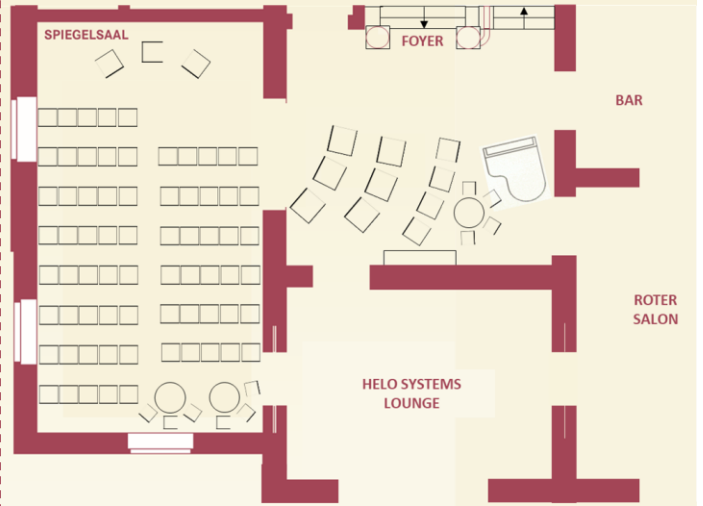

Bestuhlung 8
Stuhldreie + Foyer
bis 90 Personen

Bestuhlungsvarianten für den roten Salon

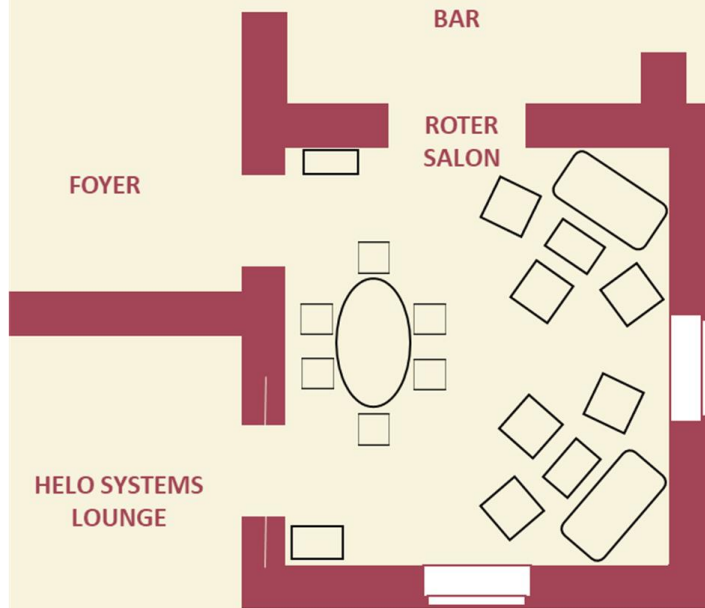

Bestuhlung 1
Lounge
16 Personen

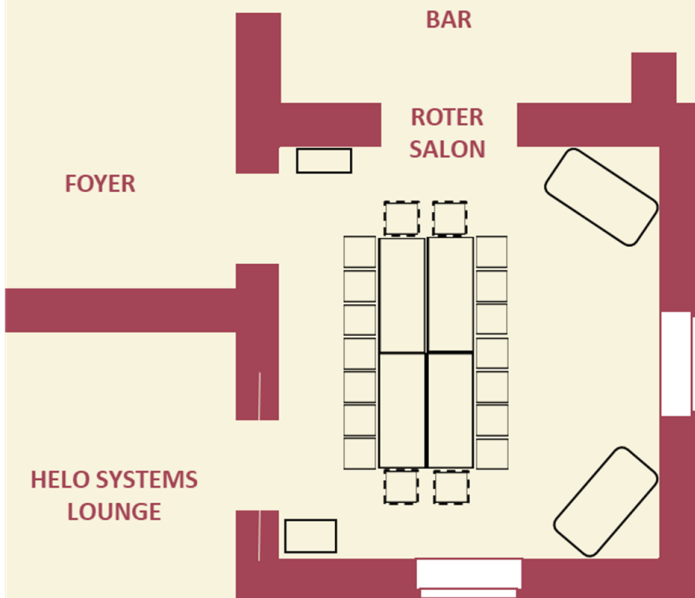

Bestuhlung 2
Block
bis 18 Personen

Bestuhlungsvarianten für die Helo Systems Lounge

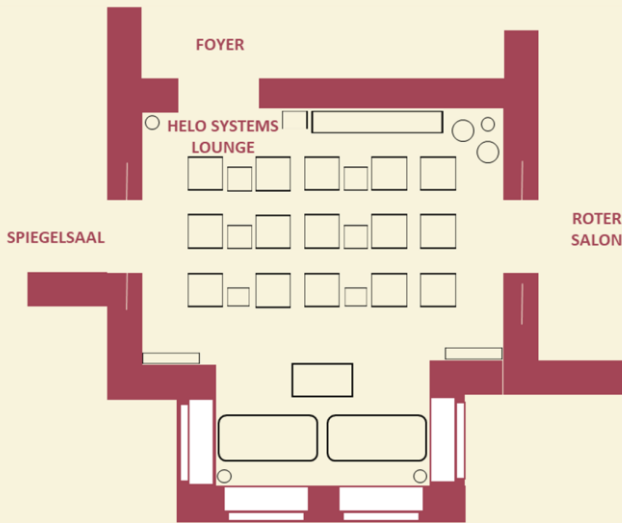

Bestuhlung 1
Lounge
19 Personen

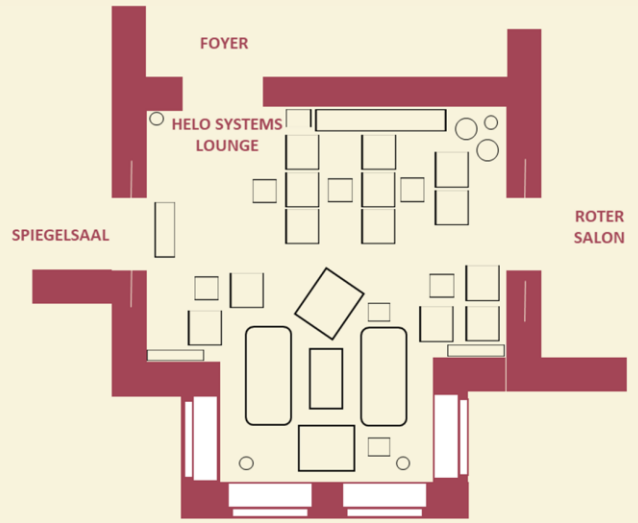

Bestuhlung 2
Lounge
20 Personen

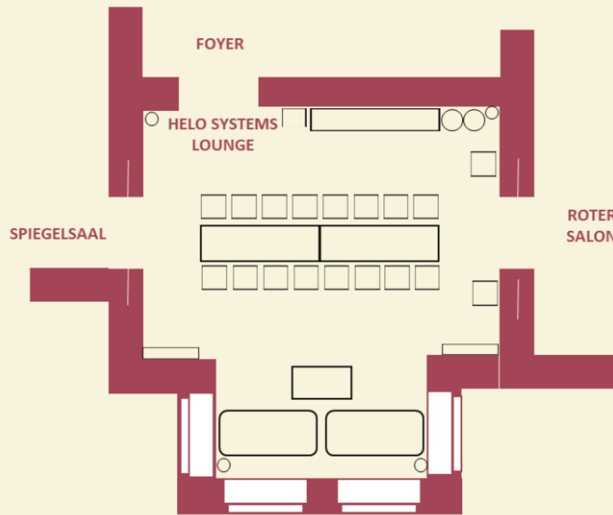

Bestuhlung 3
Tafel
16 Personen